



RHINO-RACK®

RCP95-BK Leg Supplement

Peugeot Partner/Rifter LWB (Gen3), Citroën Berlingo LWB,
Fiat Doblo LWB, Vauxhall/Opel Combo LWB, Toyota Proace
City LWB

Carrying Capacity





Check your vehicle owners hand book for vehicle maximum carrying capacity. Please ensure you use the vehicle manufacturer's maximum roof allowance if it is lower than the figure listed in this instruction.
Load must be evenly distributed over the system.

For Pioneer Load Ratings, refer to the Pioneer Fitting Chart found in Step **4**.

VISIT THE ONLINE
CALCULATOR FOR
CURRENT SYSTEM
LOAD LIMIT DATA



DYNAMIC 3 CROSS BAR LOAD LIMIT (ON AND OFF ROAD):
***USE THE VEHICLE MANUFACTURER'S MAXIMUM ROOF ALLOWANCE IF IT IS LOWER THAN THE FIGURE LISTED**

 CARGO	 SYSTEM WEIGHT	 LOAD LIMIT	OR	 Max kg
UP TO 92.5 KG 204 lbs	7.5 KG 16.5 lbs	UP TO 100 KG 220 lbs		*VEHICLE MANUFACTURER'S ROOF LOAD LIMIT

3 BARS



1

Flathead
Screw-
driver

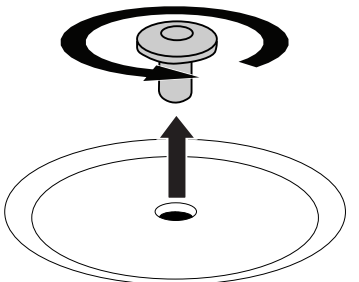

NOTE: Store factory plugs in
safe place.



For Pioneer Fits:

- For **1300mm long** Pioneers remove only the middle and rear plugs. (Base kit not required to be installed at the Front).

- For **1900mm long** Pioneers remove only the front and middle plugs. (Base kit not required to be installed at the Rear).

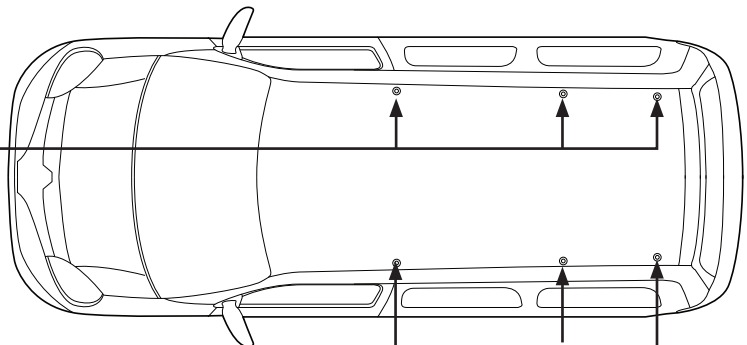

3 Crossbars fits:

For 3-bar fit remove **all** factory
plugs.

Front Bar
Middle Bar
Rear Bar

2

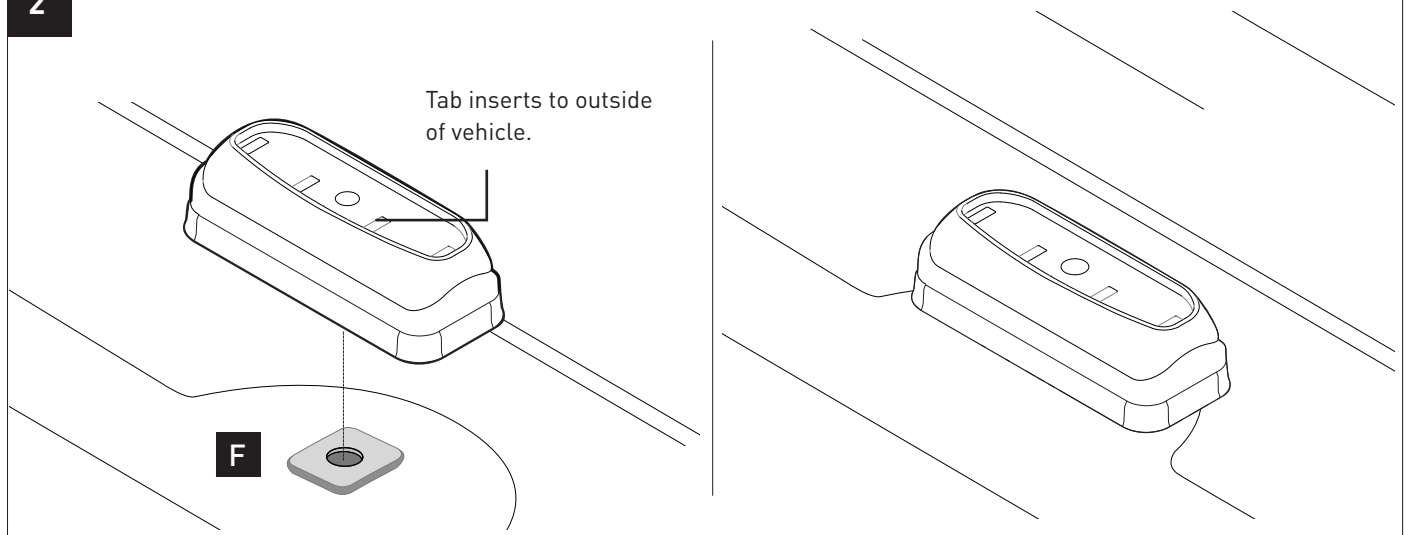

NOTE: For Pioneer fitments, not all components in RCP95-BK and RCHT6 will be required.

3 Loosely attach legs with spacers, as detailed below, to the Crossbars or Platform before bolting the **RCHT6** legs to the vehicle.

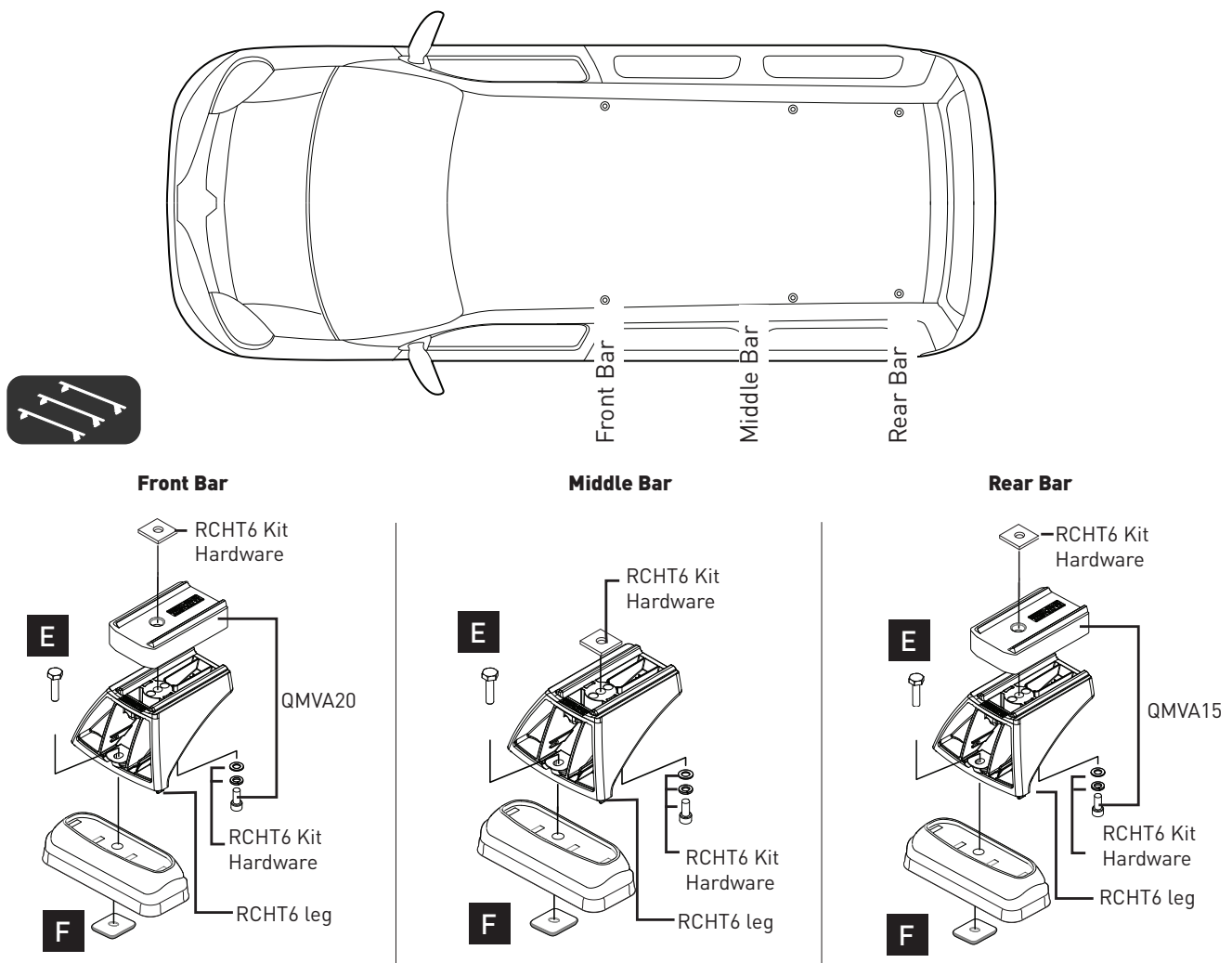

NOTE: When using the **QMVA20** spacer, use the hardware provided in the spacer kit.

Components **E** & **F** can be found in the RCP-95 kit.

NOTE: For 1300mm long Pioneers - Only use the middle and rear leg with spacer setup shown above.
For 1900mm long Pioneers - Only use the Front and Middle leg with spacer setup shown above.



PLATFORM INSTALLATION

4



rhinorack.com/roof

1. Complete **Fit my vehicle** journey
2. Select your **Product Solution**
3. Scroll down to '**Product Details**'
4. Select the '**INSTRUCTIONS**' tab to View the Fitting Chart
5. Space your Underbars to the **A, B & C** dimensions provided.

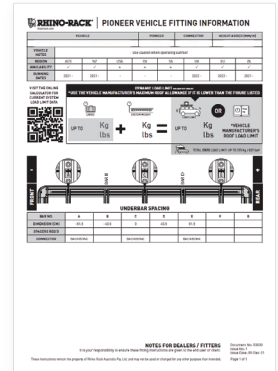

VIEW FITTING CHART
Example only

